

Cat. No.	Category	Test Item	Diseases	Specimen Type	Specimen Volume	Reaction Time	Measuring Range	Qualification	
W290	COVID-19	2019-nCoV RBD Antibody Test	COVID-19	Fingerstick or Venous	20µL	15 mins	Qualitative & Semi-quantitative	CE	
W289		2019-nCoV Neutralizing Antibody Test		WB/ S/P	75 µL serum/plasma 100 µL venous or fingerstick whole blood	15 mins	Qualitative & Semi-quantitative	CE	
W286		2019-nCoV Antigen Test		NP/ OP	/	15 mins	Qualitative	CE	
W276		2019-nCoV Antibody Test				10 µL	10 mins	Qualitative	CE
W278		2019-nCoV IgM/IgG Test				10 µL	10 mins	Qualitative	CE
W277		2019-nCoV IgM Test				10 µL	10 mins	Qualitative	CE
W280		2019-nCoV IgG Test				10 µL	10 mins	Qualitative	CE
W241	Vitamin	Vitamin D	Bone Metabolism	S/P	75 µL	15 mins	5~100 ng/mL	CE NMPA	
W207	Diabetic & Renal Injury Markers	HbA1c	Diabetes Mellitus	WB	10 µL	5 mins	4.0~14.5%	CE IFCC NGSP NMPA	
W206		MAU	Renal Injury	Urine	75 µL	3 mins	5~300 mg/L	CE NMPA	
W219		CysC	Renal Injury	S/P/WB	10 µL	5 mins	0.2~10 mg/L	CE NMPA	
W228		NGAL	Renal Injury	Urine	75 µL	15 mins	10~1500 ng/mL	CE NMPA	
W229		β2-MG	Proximal Renal Tubule Dysfunction	S/P/WB	10 µL	10 mins	0.3~20 mg/L	CE NMPA	
W231	Thyroid Function	T3	Thyroid Malfunction	S/P/WB	75 µL	15 mins	0.61~9.22 nmol/L	CE NMPA	
W232		T4	Thyroid Malfunction	S/P/WB	75 µL	15 mins	12.87~300 nmol/L	CE NMPA	
W220		TSH	Thyroid Malfunction	S/P/WB	75 µL	15 mins	0.1~100 mIU/L	CE NMPA	
W200		ft3	Thyroid Malfunction	S/P/WB	75 µL	15 mins	0.40~50.00 pmol/L or 0.26~32.55 pg/dL	CE	
W259		ft4	Thyroid Malfunction	S/P/WB	75 µL	15 mins	1.00~100 pmol/L or 0.078~7.77 ng/dL	CE	
W225	Fertility	β-HCG	Fertility	S/P/WB	20 µL	15 mins	2~200,000 mIU/mL	CE NMPA	
W244		LH	Fertility	S/P/WB	75 µL	15 mins	1~100 mIU/mL	CE NMPA	
W245		FSH	Fertility	S/P/WB	75 µL	15 mins	1~100 mIU/mL	CE NMPA	
W233		Prog	Fertility	S/P/WB	75 µL	15 mins	1.5~60 ng/mL	CE NMPA	
W246		PRL	Fertility	S/P/WB	75 µL	15 mins	1~200 ng/mL	CE NMPA	
W247		E2	Fertility	S/P/WB	75 µL	15 mins	9~3000 pg/mL	CE NMPA	
W248		Testosterone	Fertility	S/P/WB	75 µL	15 mins	0.2~15 ng/mL	CE NMPA	
W257		AMH	Fertility	S/P/WB	75 µL	15 mins	0.1~16 ng/mL	CE NMPA	
W202	Cardiac Markers	NT-proBNP	Heart Failure	S/P/WB	75 µL	15 mins	18~35000 pg/mL	CE NMPA	
W203		cTn I	Myocardial Infarction	S/P/WB	75 µL	15 mins	0.1~50 ng/mL	CE NMPA	
W204		Myo	Myocardial Infarction	S/P/WB	75 µL	15 mins	2.0~400 ng/mL	CE NMPA	
W205		CK-MB	Myocardial Infarction	S/P/WB	75 µL	15 mins	0.3~100 ng/mL	CE NMPA	
W217		H-FABP	Myocardial Infarction	S/P/WB	75 µL	15 mins	1~120 ng/mL	CE NMPA	
W216		3 in 1 (cTn I/Myo/CK-MB)	Myocardial Infarction	S/P/WB	75 µL	15 mins	Same with single items	CE NMPA	
W222		BNP	Heart Failure	WB/Plasma	75 µL	15 mins	5~5000 pg/mL	CE NMPA	
W223		2 in 1 (cTn I/ NT-proBNP)	Myocardial Infarction	S/P/WB	75 µL	15 mins	Same with single items	CE NMPA	
W240	hsCRP	CVD	S/P/WB	10 µL	3 mins	0.1~10mg/L	CE NMPA		
W254	TnT	Myocardial Infarction	S/P/WB	100 µL for whole blood 75 µL for plasma/serum	15 mins	0.03~10 ng/mL	NMPA		
W242	Lp-PLA2	Atherosclerosis	S/P/WB	75 µL	15 mins	10~1000 ng/mL	NMPA		
W239	Craniocerebral Injury Markers	S100β	Cerebral Ischemia Cerebral Hemorrhage	S/P/WB	75 µL	15 mins	0.05~10 ng/mL	NMPA	
W211	Coagulation	D-Dimer	Thrombosis	WB/Plasma	15 µL for whole blood 10 µL for plasma	5 mins	0.1~10 mg/L	CE NMPA	
W227		One step D-Dimer	Thrombosis	WB/Plasma	100 µL for whole blood 75 µL for plasma/serum	15 mins	0.1~10 mg/L	CE NMPA	
W210	Inflammation Markers	PCT	Sepsis	S/P/WB	75 µL for whole blood 50 µL for plasma/serum	15 mins	0.1~100 ng/mL	CE NMPA	
W201		CRP (hsCRP+CRP)	Inflammation	S/P/WB	8.5 µL for whole blood 5 µL for plasma/serum	3 mins	0.5~200 mg/L	CE NMPA	
W218		2 in 1 (CRP+PCT)	Infection & Inflammation	S/P/WB	75 µL	15 mins	CRP:0.5~150 mg/L PCT:0.1~100 ng/L	CE NMPA	
W221		SAA	Infection & Inflammation	S/P/WB	10 µL	15 mins	1.0~300 mg/L	CE NMPA	
W251		IL-6	Inflammation	S/P/WB	75 µL	15 mins	3~4000 pg/mL	NMPA	
W208	Tumor Markers	AFP	Liver Cancer	S/P/WB	75 µL	15 mins	5~400 ng/mL	CE NMPA	
W209		PSA	Prostate Cancer	S/P/WB	75 µL	15 mins	2~100 ng/mL	CE ₀₁₂₃ NMPA	
W226		CEA	Cancer	S/P/WB	75 µL	15 mins	1~500 ng/mL	CE NMPA	
W230		fPSA	Prostate Cancer	S/P/WB	75 µL	15 mins	0.2~30 ng/mL	CE ₀₁₂₃ NMPA	
W250	Others	Cortisol	Cortisol disorders	S/P/WB	75 µL	15 mins	50~1000 nmol/L	NMPA	
W269		Ferritin	Iron metabolism	S/P/WB	75 µL	10 mins	5 ~ 1000 ng/mL	CE	
W279		iFOB	Gastrointestinal bleeding	Feces	stick to sample at 6 different parts of the feces	5 mins	25~1000 ng/mL	CE	

* Ongoing: Dengue NS1 Ag, Dengue IgG/IgM Antibody, IgE, ASO, RF, Anti-CCP, H.Pylori Antigen etc.



Racing For Life

Finecare™

FIA Meter II Plus SE (FS-114)

Fluorescence Immunoassay Analyzer

Fluorescence Immunoassay Analyzer

FS-114

- Dimension : 239 x 278 x 148mm
- Weight : 3.3kg

Built-in Thermal Printer

- Real-time auto-printing
- Support for external printer

Connectivity

- Wifi connection to LIS/HIS
- RS 232 and Ethernet port
- 4 USB ports

ID Chip Port

- Automatically reading of batch number and calibration information in the ID chip

Designed Sampler

- Specially-designed sampler for small volume of specimen

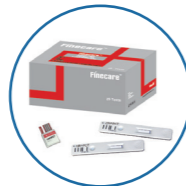

Linux System

- Smooth operation
- Security system
- Custom intelligent management module
- Multi-user management

Large Display

- 8" LCD Capacitive touch screen
- Intuitive user interface

Portability

- 7800mAh battery
- Internal rechargeable battery
- 21-hours stand by time
- ≥200 tests without power supply

Test Device Tray 40+ Test Items

- Multiple testing modes available
- Unique quick mode for largenumber of samples

Test Reagent

- Suitable for whole blood,serum, plasma and urine
- Room temperature storage
- Get results in 3-15 minutes

Technical Advantages



Portable

- Small size,
- 7800mAh built-in battery



Convenient

- Easy to operate,
- large curved handle



Instant Results

- Get results in 3-15 minutes



Reliable Accuracy

- Good correlation with CLIA method



Temperature Control

- Provide better reaction condition



Operation Procedure

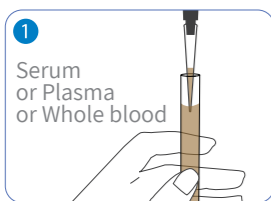

Sampling

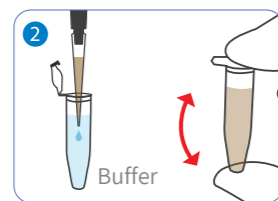

Mixing

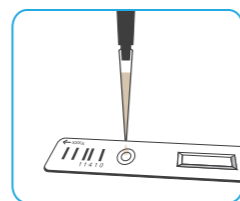

Dropping

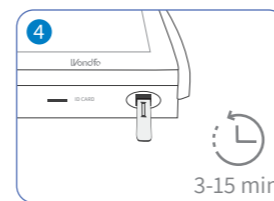

Reading

Application



Laboratory



ER



Ambulance



Clinics



ICU



Clinical department